

PERFIS À PRONTA ENTREGA

**AMADEIRADO
CEREJEIRA REAL**

ALUMICHAPAS®
COMÉRCIO DE ALUMÍNIO E ACRÍLICO LTDA.

ÍNDICE ANALÍTICO PERFIS

CÓDIGO	KG/M	PÁG
P30-023	0,546	1.1
P30-034	0,267	1.1
P30-082	1,086	1.1
P30-377	1,081	1.1
P42-007	1,245	1.4
P42-012	0,822	1.4
P42-014	0,349	1.4
P42-032	1,356	1.4
PBG-010	0,115	1.2
PBG-023	0,202	1.5
PBG-037	0,211	1.5
PCT-005	0,130	1.8
PFC-087	0,942	1.9
PLB-075	0,958	1.7
PLB-108	0,843	1.7
PLB-165	1,354	1.7
PME-075	0,657	1.6
PME-078	1,045	1.6
PME-079	0,132	1.6
PPC-003	0,960	1.8
PPC-004	0,658	1.8
PPN-001	0,885	1.3
PPN-002	0,542	1.3
PPN-003	1,322	1.3
PPN-004	0,448	1.3
PRM-005	0,184	1.8
PTQ-017	0,802	1.9

EDIÇÃO I - JUN 2021

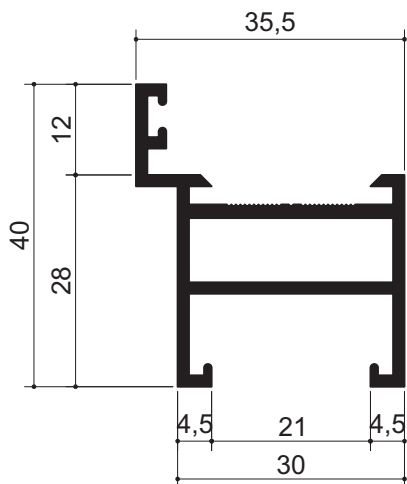
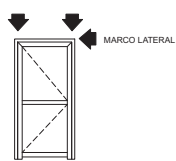

P30-023
Marco
0,546 Kg/m

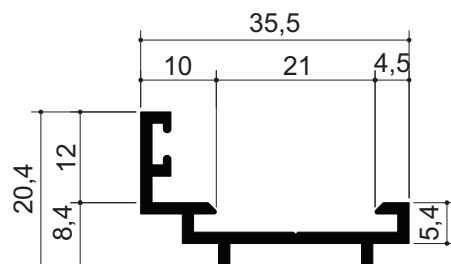
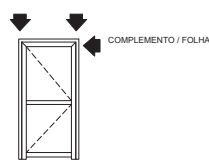

P30-034
Batedeira
0,267 Kg/m

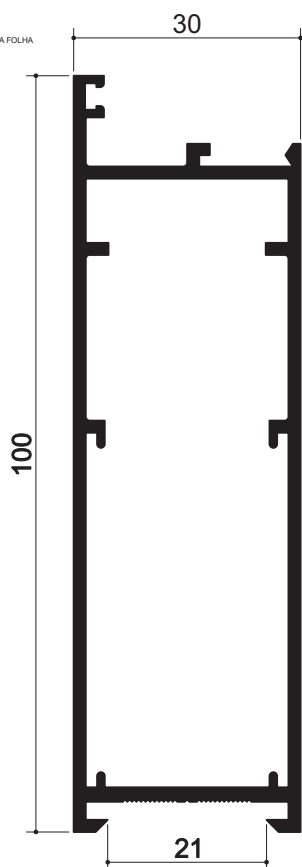
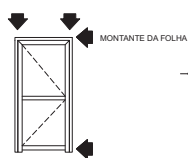

P30-082
Folha
1,086 Kg/m

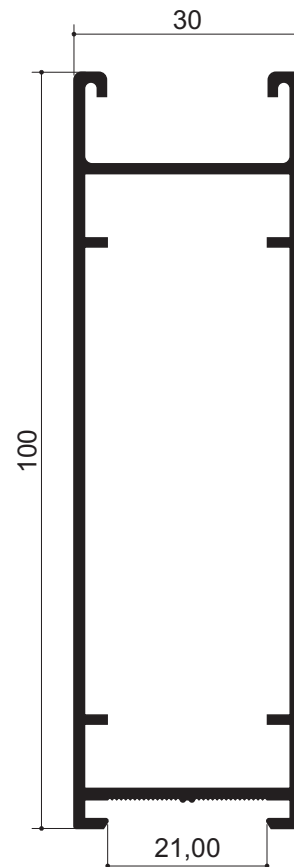
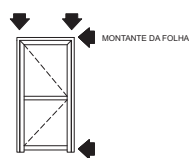

P30-377
Altura da Folha
1,081 Kg/m

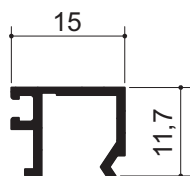
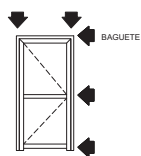

PBG-010
Baguete
0,115 Kg/m

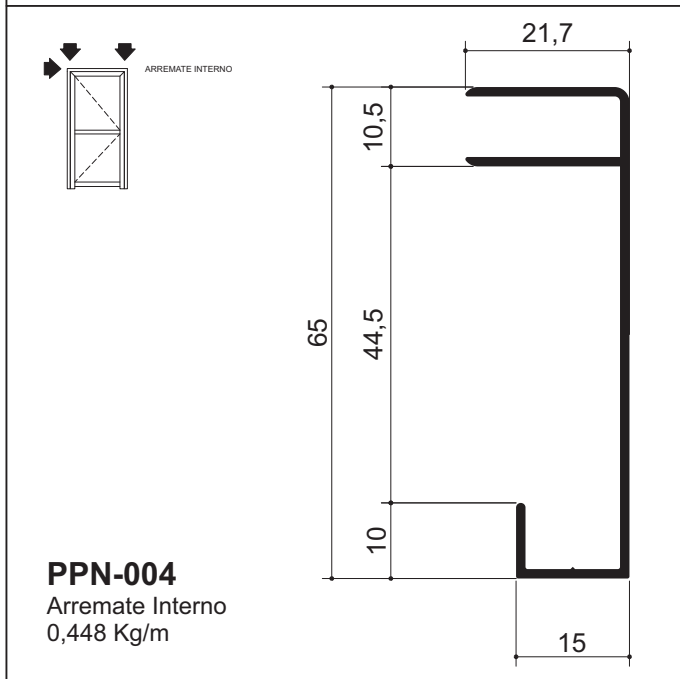
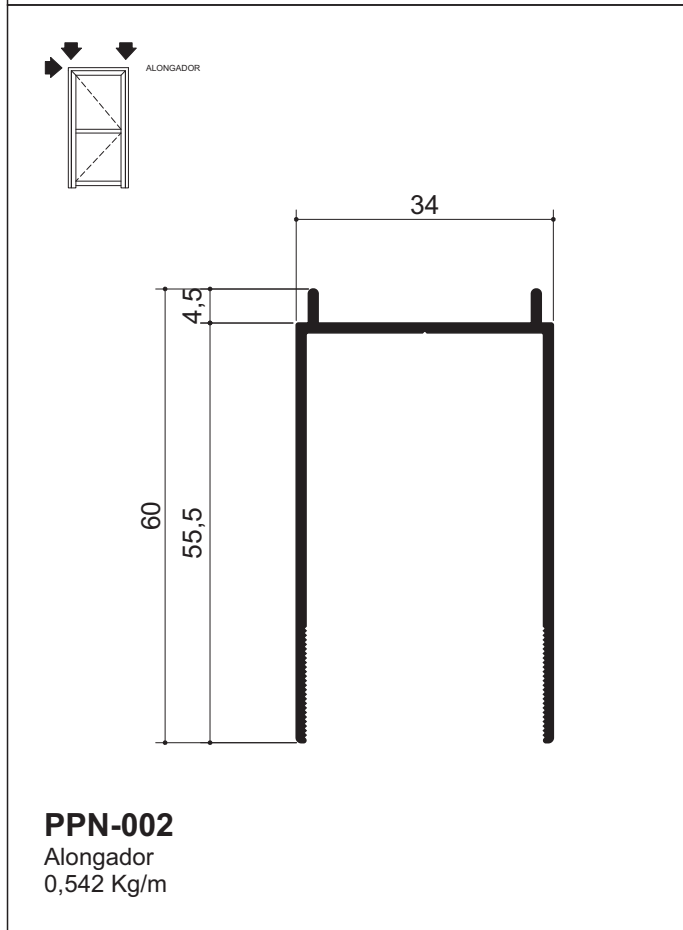
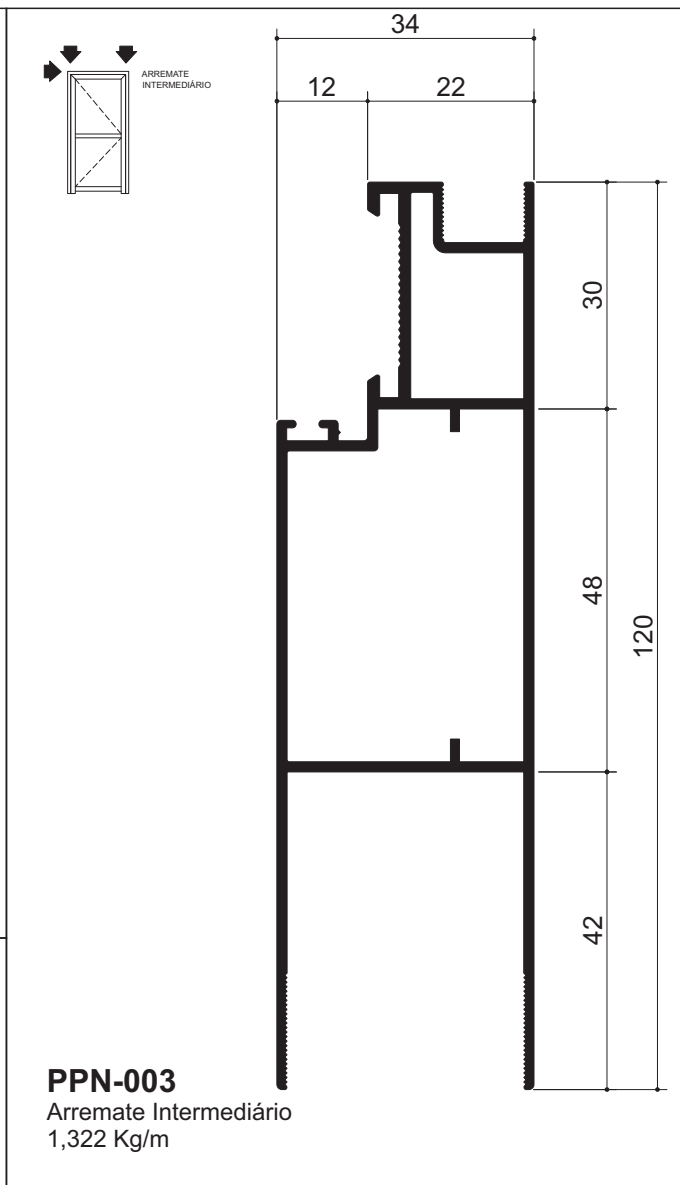
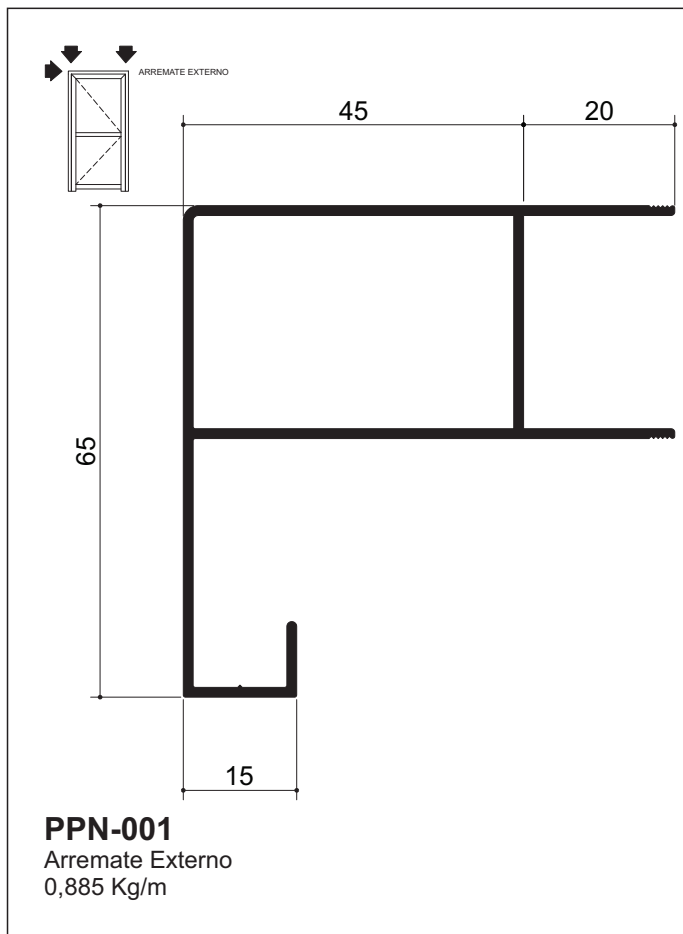

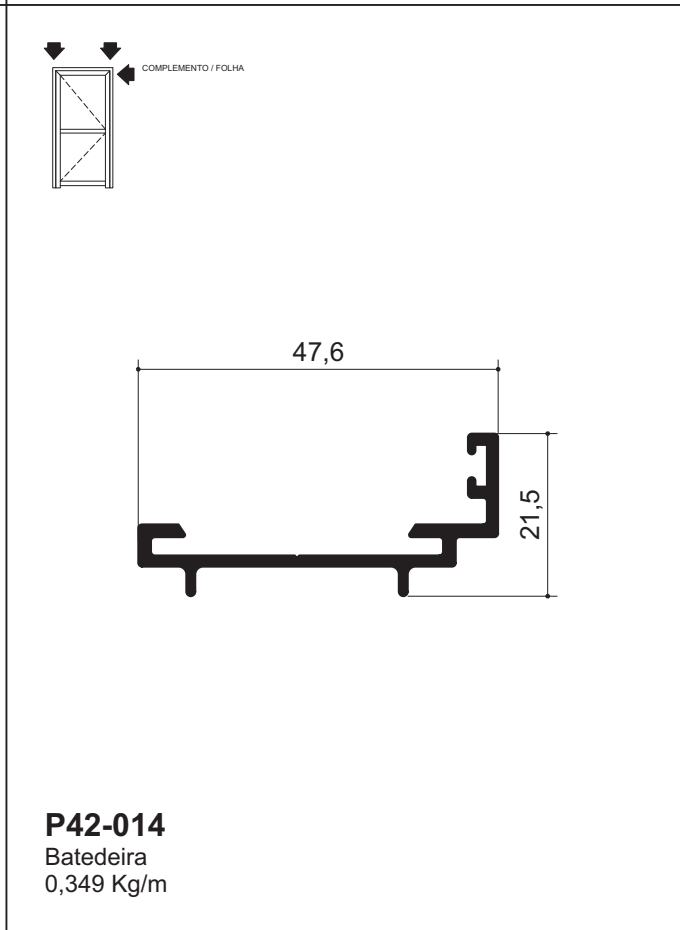
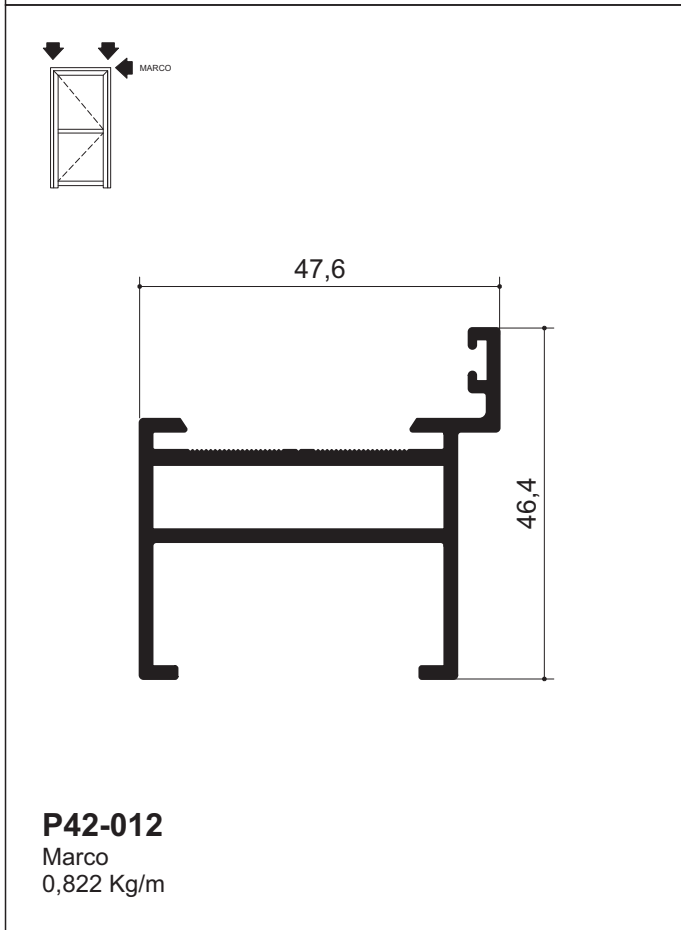
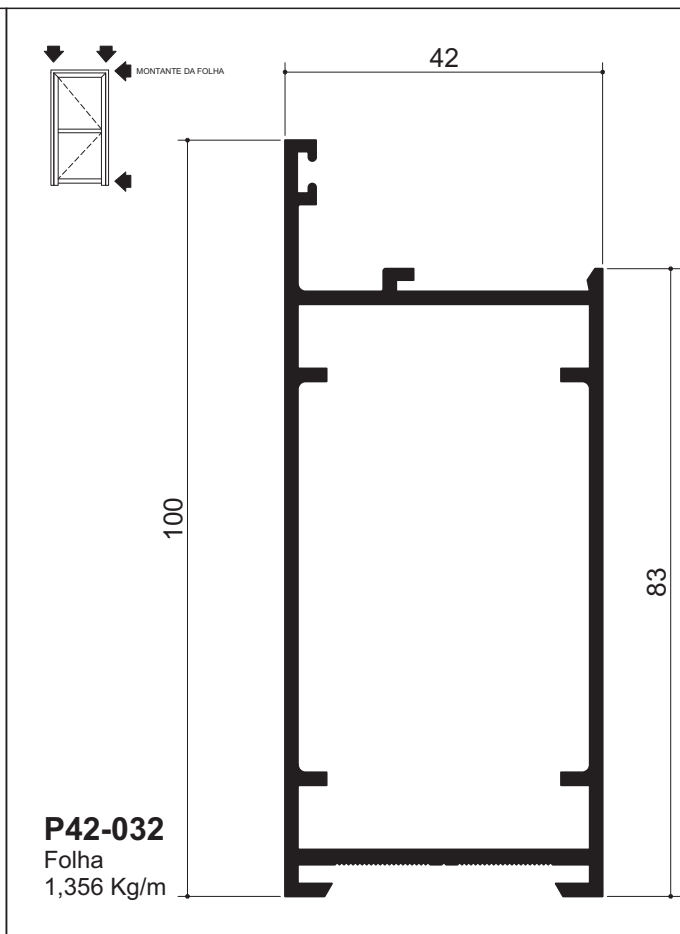
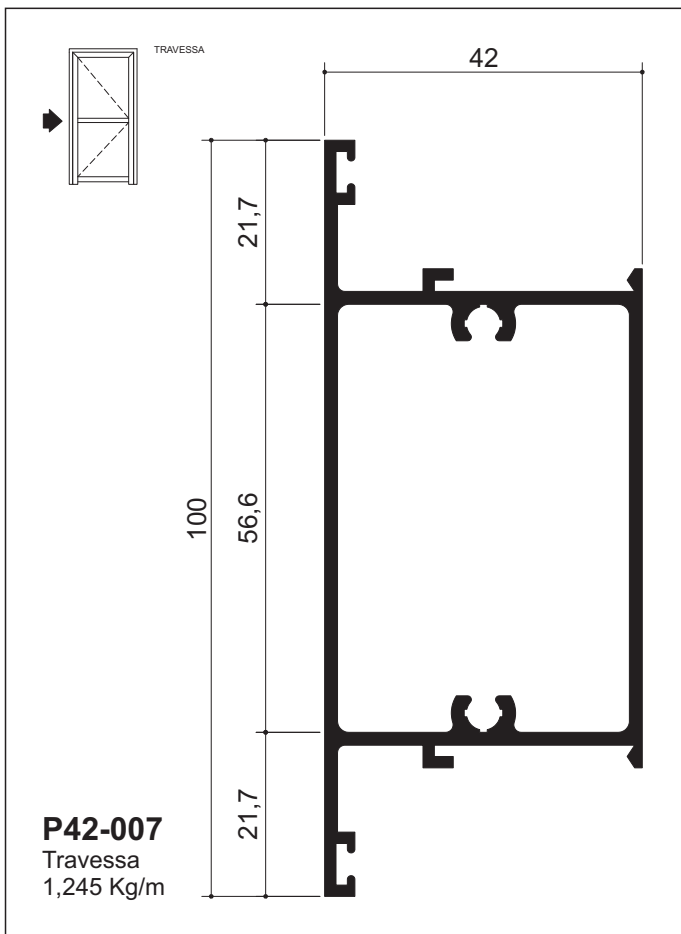

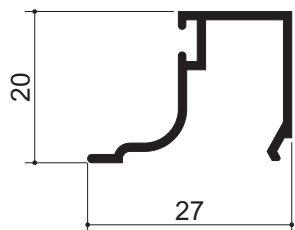
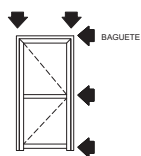

PBG-023
Baguete
0,202 Kg/m

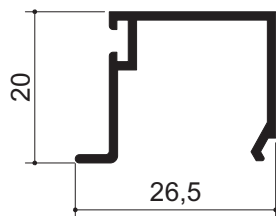
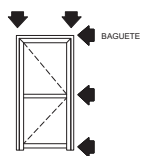

PBG-037
Baguete
0,211 Kg/m

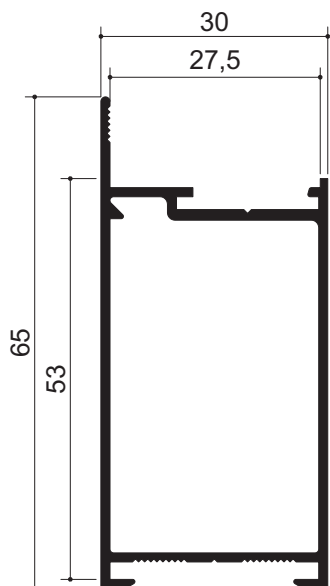
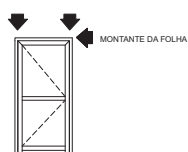

PME-075
Marco
0,657 Kg/m

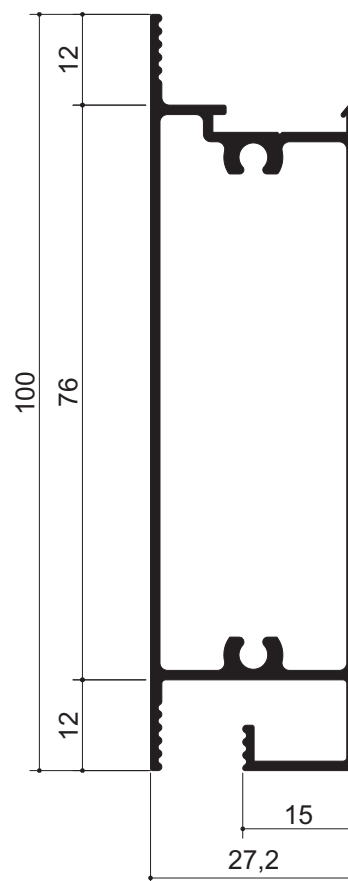
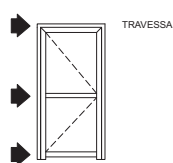

PME-078
Marco/Travessa
1,045 Kg/m

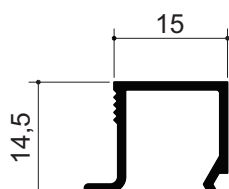
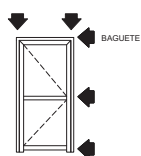

PME-079
Baguete
0,132 Kg/m

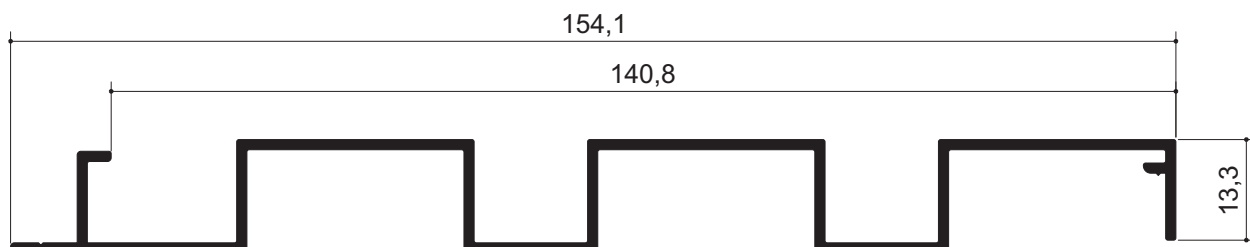

PLB-075

Lambri
0,958 Kg/m

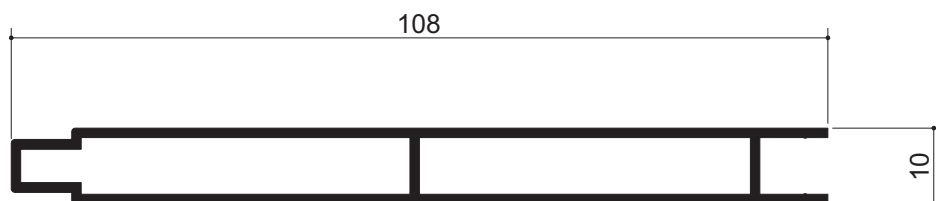

PLB-108

Lambri
0,843 Kg/m

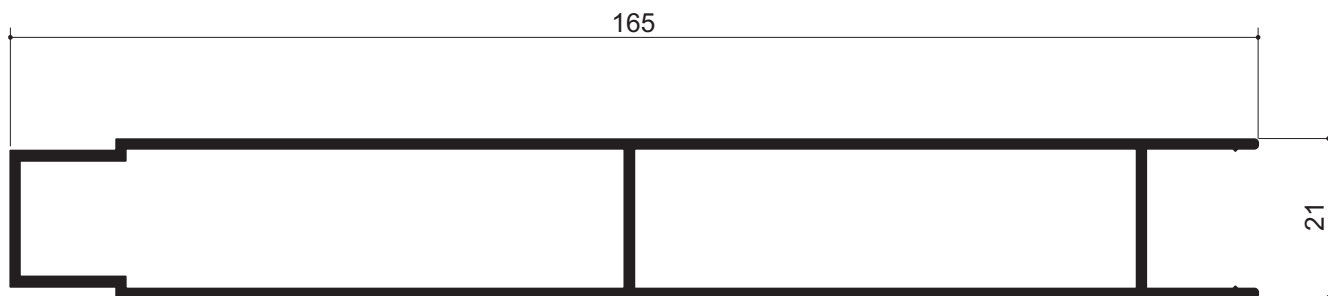

PLB-165

Lambri
1,354 Kg/m



PRM-005
Arremate
0,184 Kg/m

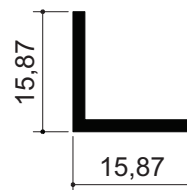

PCT-005
Cantoneira
0,130 Kg/m

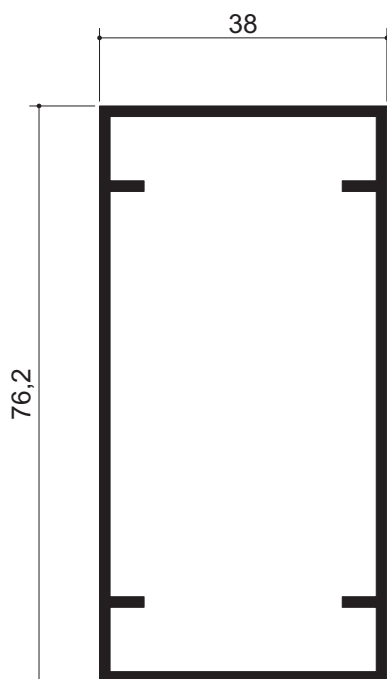

PPC-003
Frisado
0,960 Kg/m

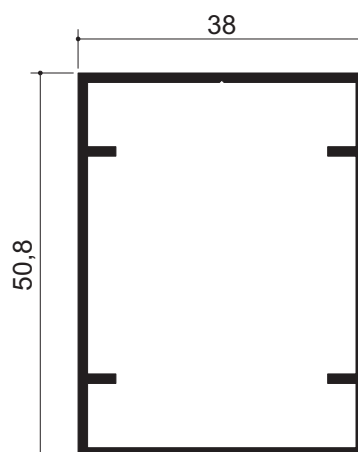

PPC-004
Frisado
0,658 Kg/m

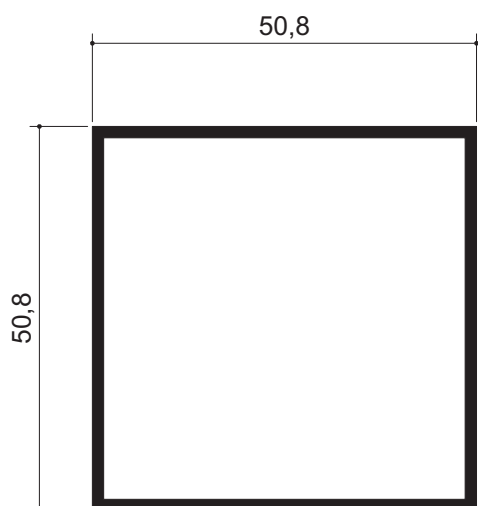

PTQ-017

Tubo Quadrado 2"
0,802 Kg/m

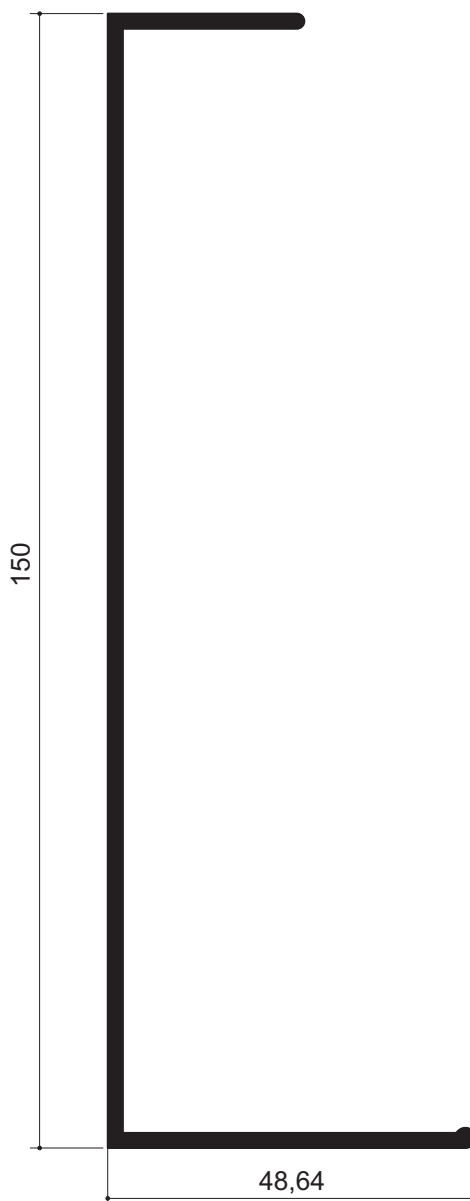

PFC-087

Rufo
0,942 Kg/m

ALUMICHAPAS[®]

Rua Gaspar Ricardo, 379 - Zona 10
CEP: 87040-365 | Maringá - PR
(44) 3033-1500 | (44) 9 9164-0107
www.alumichapas.com.br

ALUMICHAPAS[®]
COMÉRCIO DE ALUMÍNIO E ACRÍLICO LTDA